



Unity place

Events & Conferences

Where Innovation Meets Inspiration



Unity Place is a future-forward collaboration of inspiring, sustainable workplace, conference, leisure, and event spaces. Together they make an inclusive community powered by sustainability and a planet-first approach.

Our venue

Conveniently located next to Milton Keynes railway station, Unity Place is an exceptional, state-of-the-art venue in the heart of England.

An outstanding, well-equipped and sustainable venue, Unity Place will ensure your event delivers an experience that exceeds expectations. Whether an industry conference, glitzy awards ceremony, black tie dinner or a business get-together, our central location, experienced team and exceptional catering bring together everything you need for success.

Our stunning event spaces are modern, accessible and well equipped, bringing professionalism and the perfect ambiance to your event. Our friendly team will work with you to create an exciting event in the spaces that suit your needs and budget. We offer competitively priced, flexible packages, that can include bespoke options.

Conferences, exhibitions, canapé receptions and more; we have the perfect space to unite your delegates in one place.



Core pillars

Our core pillars are central to everything we do at Unity Place from our building to our beautiful food.

- Sustainability 
- Collaboration 
- Innovation 
- Community 
- Experience 

Sustainability

We are passionate about not only 'doing the right thing' but making it easier for our guests to make 'planet-friendly' choices.



01.

We are committed to a net zero target by 2030

03.

We have a British-first sourcing policy on all fresh produce and we are proud to have invested in many longer term partnerships

05.

All our meat, dairy and poultry is Red Tractor farm assured

07.

We only use fish which is Marine Conservation Society certified

02.

Over 90% of our fresh produce is sourced locally in the UK

04.

All our fresh eggs are British free-range or organic

06.

We only use pole and line-caught tuna, a sustainable fishing method used to catch tuna, one fish at a time

08.

All our fresh and frozen prawns are Marine Conservation Society certified

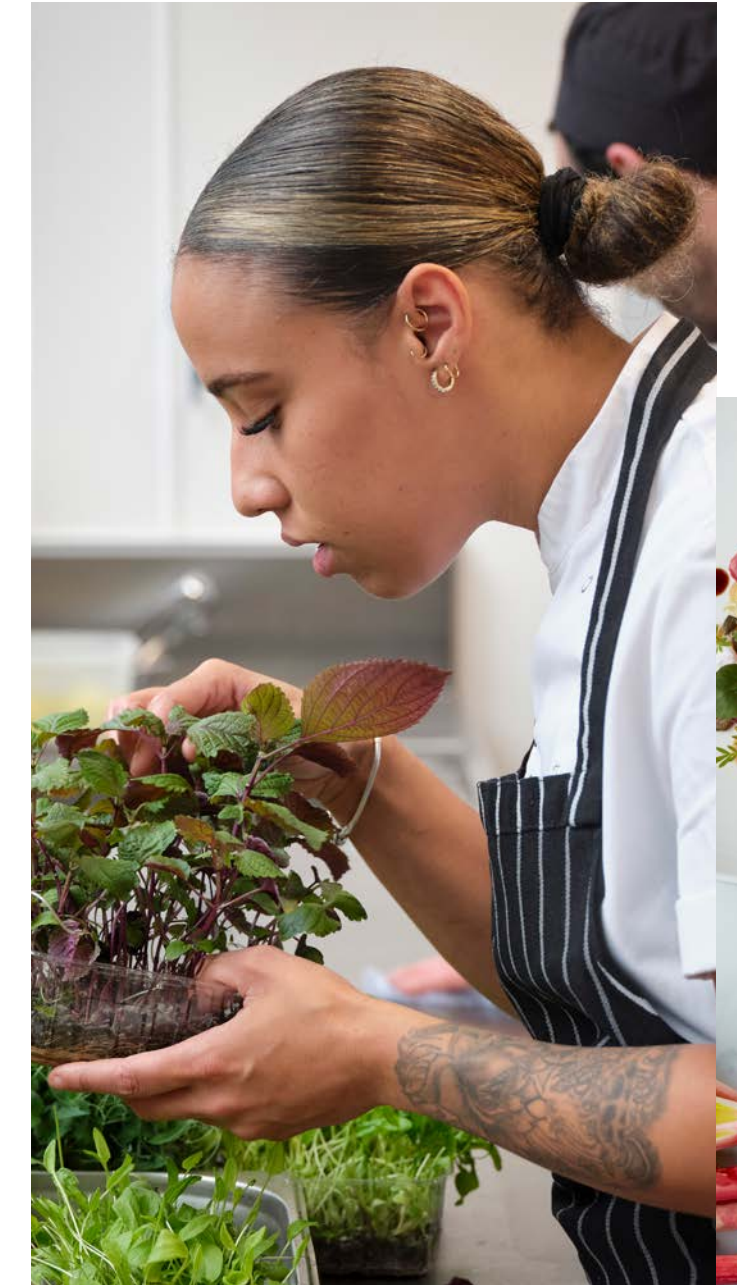

Unity place





Events and Conferences

A sustainability led venue

As a landmark destination in Milton Keynes, we aim to shape the landscape with a future-forward, multi-purpose facility that champions environmental stewardship.



Rainwater harvesting

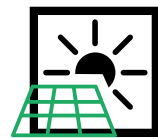

PV Solar panels offsetting 40 tonnes of CO² per year



Home to a B-Corp certified business



EPC TARGET B



Zero carbon (with carbon offsetting payment to council)



Interior planting to improve air quality

BREEAM
delivered by bre

Targeting a BREEAM 'Excellent' rating



World Architecture Festival Awards, Nominee, 2022



Designed to WELL principles

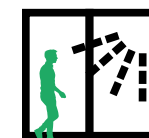

Floor to ceiling glazing maximises natural daylight and views



Exposed concrete structure providing thermal mass



Biodiversity increased with extensive planting and bird, bat and insect boxes across the terraces



Electric Vehicle Charging Points



Peak load shedding via large scale green energy storage

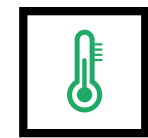

Rejected heat from local plant provides a low carbon energy source to heat the building



Brise soleil shading helps to reduce cooling loads



Secure basement cycle storage



Low energy LED lighting and motion controls



Our spaces

Unity Place offers several amazing spaces, all equipped with high-speed internet, each of which can be hired individually, or as a combination of options to create an exceptional event.



Whether you want to accommodate many or a few delegates, need full audio-visual, digital screens, and controllable lighting, or modern, light spaces with access to an outdoor terrace, we have just what you need to deliver stylish in-person events. These spaces work exceptionally well together for business meetings, awards ceremonies, product launches and post-conference dining, but it's your space to showcase your own incredible event.



Space	Location <small>Tables of 10</small>	Cabaret	Theatre	Reception	Boardroom	U-Shape	Dining
Auditorium	Ground floor	-	300	-	-	-	-
Event Space 1	First floor	120	150	150	-	-	130
Event Space 2 and 3	First floor	80	80	150	-	-	-
Event Space 2	First floor	40	40	50	20	24	-
Event Space 3	First floor	80	100	100	24	30	80
Urban Food Market	Ground floor	-	-	400	-	-	315
Urban Food Market	Mezzanine	-	-	60	-	-	40
Unity Sky Lounge	7th floor	-	-	120	-	-	78
Unity Sky Lounge terrace	7th floor	-	-	50	-	-	-
Dipna's at Unity Place	Mezzanine	-	-	-	-	-	50
Dipna's at Unity Place	Ground floor	-	-	120	-	-	120



auditorium

A modern event space with bench seating in a theatre style layout to seat up to 300, the Auditorium is equipped with a large digital screen, full audio visual, and a raised stage area.

It provides an exceptional venue for dynamic conferences, awards ceremonies and industry talks. High speed internet and state-of-the-art technology means you can engage your audience to get actively involved: ask questions, vote in polls and be a part of the discussion in real time.



auditorium AV facilities included in venue hire

- 6.5m x 3.5m digital LED screen
- Connect via wireless
- Spot and wash lighting
- Renkus Heinz sound system
- 2 microphones as standard
- BT's next generation ultrafast Wi-Fi 6 network provides high speed internet access for visitors to the building

Optional extras (require AV support)

- Additional microphones for speakers
- Broadcast content
- Recording
- Split the digital screen with multiple content
- Lectern hire
- Crowd mics (biamp.com)



auditorium

Foyer screens at Unity Place

The Station and City side entrance foyer areas act as entrances to Unity Place and provide an immersive experience from the very start of your event.

Why not use the state of the art LED screens to amplify your event? Unity Place has been designed with the highest technological specifications in mind, equipped with state of the art technology throughout.

Please contact the events team for more digital options to create an immersive experience for delegates or to amplify your brand.

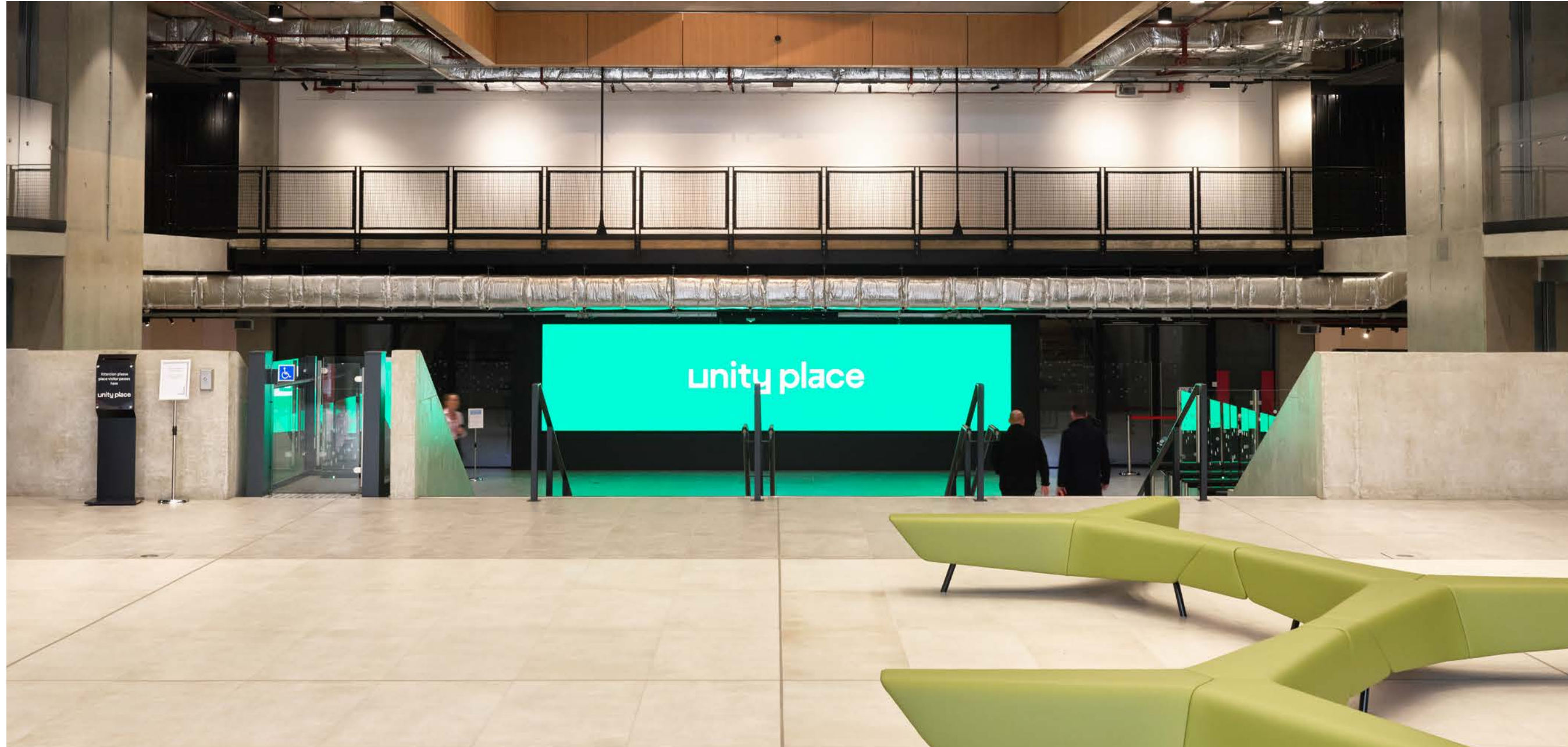



event spaces

Event spaces 1, 2 and 3 are modern, spacious and well-equipped, located on Level 1 above the Auditorium. Event space 1 and event spaces 2 and 3 combined, have the capacity to accommodate up to 150 delegates in a variety of layouts enhanced with large digital screens.

These spaces benefit from floor to ceiling windows flooding the room with natural daylight. Event spaces 2 and 3 have a partition wall, allowing for a separate catering area or smaller syndicate room. Event space 3 can accommodate up to 100 delegates and event space 2 up to 40 delegates.

With the option to include the auditorium and event spaces together in your package, this addition works exceptionally well for awards ceremonies, break out spaces and post-conference events.



event space 1 AV facilities included in venue hire

- 146" Samsung 4k UHD main screen
- 2 X 85" Samsung 4k UHD repeater screens
- Connect via wireless
- Renkus Heinz sound system
- 2 microphones as standard
- BT's next generation ultrafast Wi-Fi 6 network provides high speed internet access for visitors to the building

Optional extras (require AV support)

- Additional microphones for speakers
- Broadcast content
- Recording
- Split content by screen
- Stage hire
- Lectern hire
- 85" Samsung touch screen
- Zoom/teams meeting capabilities

event space 2 and 3 AV facilities included in venue hire

- Room can be combined or split
- 1 X 146" Samsung 4k UHD
- 2 X 85" Samsung 4k UHD
- Connect via wireless
- Renkus Heinz sound system
- 2 microphones as standard
- BT's next generation ultrafast Wi-Fi 6 network provides high speed internet access for visitors to the building

Optional extras (require AV support)

- Additional microphones for speakers
- Broadcast content
- Record
- Split content by screen
- Stage hire
- Lectern hire
- 85" Samsung touch screen
- Zoom/teams meeting capabilities

event space 2 and 3

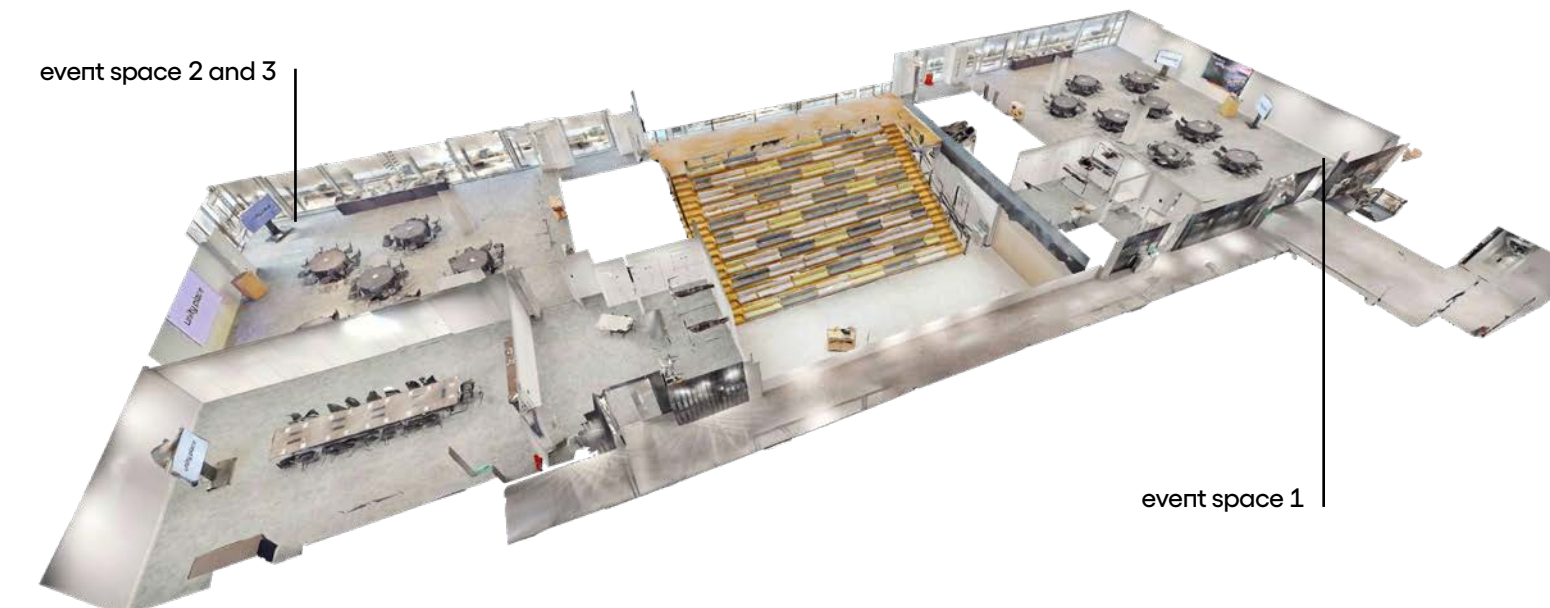

event space 1



Audio Visual Innovation

Audio Visual Technical Equipment at Unity Place



Self service

Additional AV technician

	Auditorium	Event Space 1	Event Space 3	Event Space 2/3
Digital Screen	Yes	Yes	Yes	Yes
HDMI connection to Digital screens	Yes	Yes	Yes	Yes
Renkus Heinz PA System - 20-30 ceiling speakers	Yes	Yes	Yes	Yes
Lecturn microphone	Yes	Yes	Yes	Yes
Handheld microphone	Yes	Yes	Yes	Yes
Lapel microphone	Yes	Yes	Yes	Yes
Background music	Yes	Yes	Yes	Yes
InfraRed	Yes	No	No	No
Fixed stage lighting	Yes	No	No	No
Teams calls, Zoom Meetings	Yes	Yes	Yes	Yes
Video cameras	Yes	Yes	Yes	Yes
Live streaming to other spaces	Yes	Yes	Yes	Yes
Live recording	Yes	No	No	No
Samsung Trolley mounted 85 inch repeater screens	No	Yes	Yes	Yes
Crowd mics	Yes	Yes	No	No
External production	Yes	Yes	Yes	Yes

Events and Conferences

urban food market

Complete with a large digital screen, our Urban Food Market can cater for up to 400 delegates.



Unity place

Available as part of our multi-space hire event package, the accompanying catering is a truly delicious experience with sustainably sourced ingredients.

This is a dynamic and fashionable space that suits fresh, innovative events and receptions.



Additional Dining Option

dipna anand kitchen



Celebrity Chef Dipna Anand brings her authentic and healthy signature Punjabi and South Indian cuisine to Unity Place.

This contemporary and stylish restaurant has a modern mezzanine that is available to hire for groups up to 40 guests for lunch or dinner.

Dipna is proud to champion great tasting vegetarian and plant-based recipes alongside ethically sourced meats at her restaurant, with the menu comprising of revisited classics on small plates; her well-loved and familiar curries alongside some new and unexpected menu items; and a grill that will serve tandoori lamb chops, salmon, chicken and paneer tikka, as well as lamb seekh kebab.



Unity place

Additional Dining Option



TOAST BREWING

Our on-site micro-brewery which provides delicious craft beer for the building.

To combat food waste, surplus bread from our bakery is used in the production of our beer.



All of our bread and pastries are produced on site in our artisan bakery

Here, apprentices learn first-hand as part of our giving back programme for the local community.

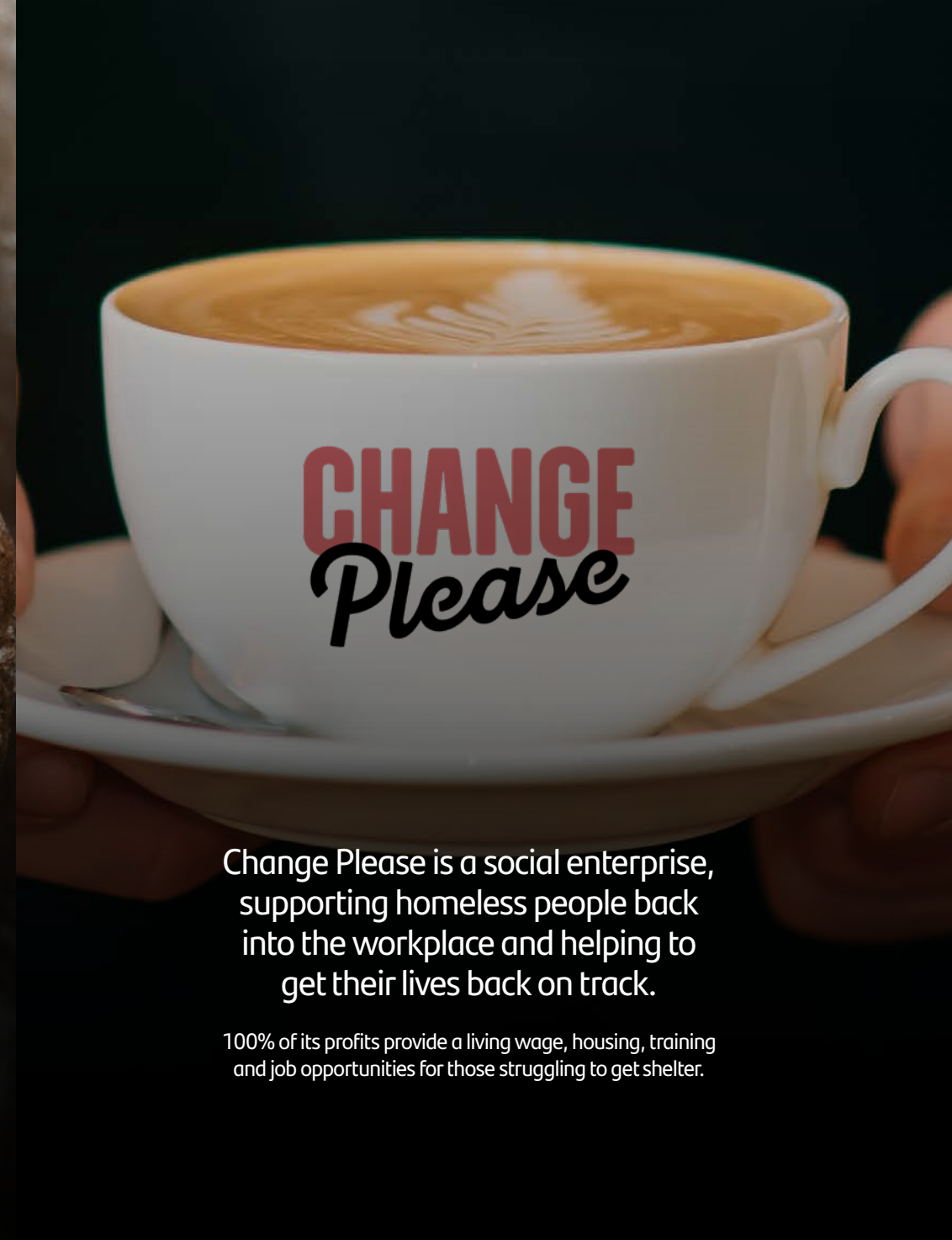

Change Please is a social enterprise, supporting homeless people back into the workplace and helping to get their lives back on track.

100% of its profits provide a living wage, housing, training and job opportunities for those struggling to get shelter.



The Corner Store at Unity Place offers a new kind of shopping experience.

Browse products in store and make purchases online in a check-out free, contactless environment, with no paper receipts.

Additional Dining Option

unity sky lounge

Our luxury rooftop sky lounge offers beautiful views, a stylish al fresco terrace, the finest British tapas and signature drinks, including seasonal cocktails and English wine.

Accessed by direct lifts, the Unity Sky Lounge is available for small groups and large reception parties, making it an ideal location for soirées, business networking events and celebrations with that extra sparkle.

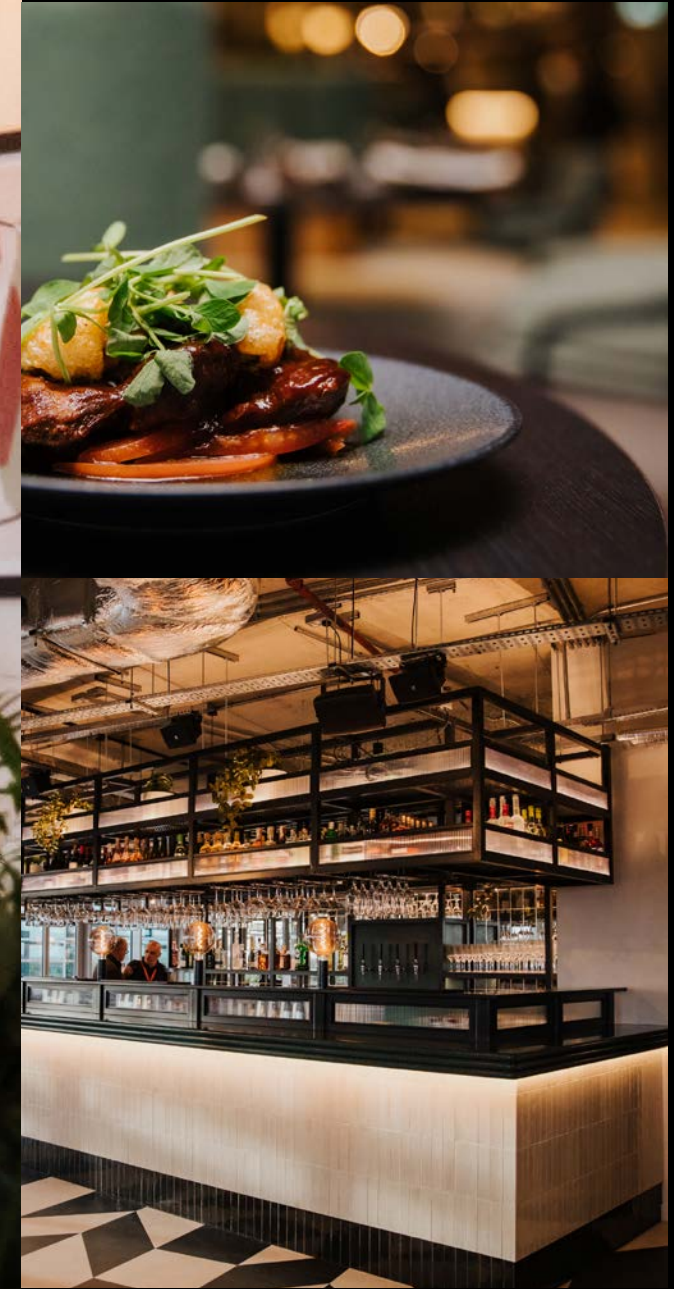



Binky Nixon
Photography

Semi Private Hire

What's included

- Semi private hire of 'Snug' area
- Two drinks per person
- Circulation of bar snacks
- Event Security & cloak rail

*Minimum numbers and spend applies



Binky Nixon
Photography

Exclusive hire packages

What's included

- Exclusive hire of Unity Sky Lounge with panoramic views of the city (between 5pm - 11pm)
- Dedicated event management
- Two drinks per person
- Circulation of bowl food from the Unity Sky Lounge menu, 3 savoury & 1 dessert per person
- Event Security & cloak rail

*Minimum numbers and spend applies



Hospitality menus

Choose your menu from a selection of deliciously different food and drink choices featuring international flavours, classic cuisines and contemporary options.



Satisfy your budget and tastes, whilst supporting a healthy lifestyle and planet.



Day delegate packages

Our day delegate meeting room package is designed to offer you and your delegates the perfect day away with everything you need for a successful and comfortable conference.



What's included

- Room hire of plenary room & catering space (between 8.30am – 5.30pm)
- Dedicated event management
- Conference stationery
- Complimentary Wi-Fi
- AV facilities in plenary room for presentations
- Arrival, morning and afternoon refreshment breaks to include a selection of teas and freshly brewed coffee, each complimented by a freshly baked item from the Baker's Room
- Two course hot & cold buffet lunch
- Hydration station
- Fresh fruit basket throughout the day
- Local pay-as-you-go car parks
- Hire extensions available upon request

Speak to our events team about curating the perfect package and pricing for your event.



Sample menu

Starter

Soup station
Homemade vegetarian daily soup, served with bread roll and Netherend farm butter.

Rye's deli sandwiches & wraps

Main

Plaice Goujons

Seared Halloumi v

Accompaniments

Lemon and Thyme Potato Wedges, Minted Crushed Peas, Mixed Greens,

Baby Gem Salad, Fresh tartare sauce

Dessert

Salted caramel and chocolate tartlet



Events and Conferences

Canapés and Reception sample package

What's included

- Drinks reception - A glass beer, wine or soft drink alternative, tray served
- A selection of 3 x / 4 x canapés

Drink & Pizza sample package

What's included

- Arrival drink
- Freshly made pizza
- Cloakroom

Additional drinks package:

- 3 drinks per person
- A glass beer, wine or soft drink alternative

Urban Food Market sample package*

What's included

- Exclusive hire of Urban Food Market from 6pm – 11pm
- Two drinks vouchers
- Choose from three artisan street food stalls
- Speciality beverage pods
- Bar facilities
- Background music

*Minimum numbers applies



About Restaurant Associates

Award winning hospitality brand Restaurant Associates are proud to cater at Unity Place.

As specialists dedicated to the delivery of exceptional dining experiences their highly skilled, passionate team are equipped with all the knowledge, support and creativity required to take your event to the next level. They constantly challenge both themselves and their guests' perceptions all whilst taking action to make a positive impact within their communities.

Their operation is underpinned by a simple but firm ethos – sustainability through a focus on seasonal menus and ethically sourced British produce.

RESTAURANT ASSOCIATES

Conveniently located

Unity Place
200 Grafton Gate
Milton Keynes
MK9 1UP

What Three Words:

///landings.passports.climate

Get in touch with our event team for more information by emailing unityplaceevents@restaurantassociates.co.uk

Travel information

Train from Milton Keynes Central Station

- Avanti West Coast - London, Manchester, Liverpool, Crewe.
- London North western railway - London, Birmingham, Northampton, Manchester.
- A fast train from London Euston to Milton Keynes Central station is just 30 minutes.

Bus and Coachway Park & Ride

- Milton Keynes Coachway service is located just off M1 J14.
- Arriva route 3 buses provide a fast and frequent connection to Central Milton Keynes, calling at Milton Keynes Central Railway Station (for Unity Place).
- Buses pick up from Bay 8 at the Coachway - under the canopy on the far right as you cross over from the car park.

Car

- M1 J14, Unity Place is an 11-minute drive west from M1 Junction 14, located on the west side of Midsummer Boulevard in Centre Milton Keynes.

International

- London Luton airport, travel is 26 miles (approx. 40-50 minutes) south on the M1.
- London Heathrow airport, travel is 55 miles (approx. 1 hour 20 minutes) south on the M1.

Walking

- Unity Place is less than 5 minutes north-west walk from MK Central Station.
- It's about 10-minute walk west from The Hub and 15-20-minute walk west from the shopping centre.

Cycle

- Electric bike pick-up and drop off points are located on the east City entrance side of the building.

Parking

- There are over 20,000 car parking spaces around Milton Keynes and several car parks next to Unity Place.

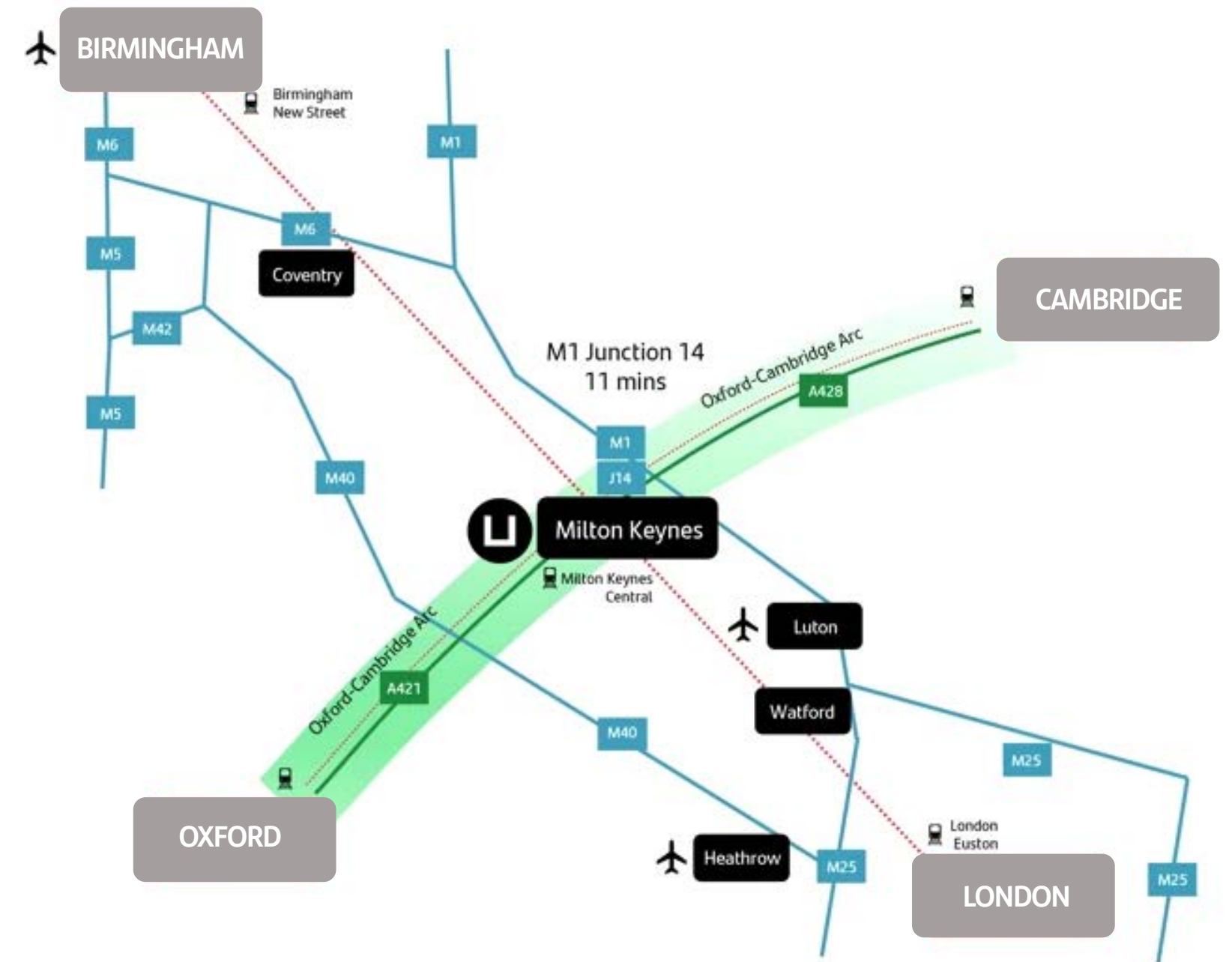

Events and Conferences

Stay local

Unity place are partnered with Moxy Hotel, Milton Keynes

It's time to stay somewhere that lets you be you. Designed to give guests just what they need to travel how they like, Moxy dares to bend all the rules — that means smart, stylish stays without the premium price tag.

Embrace play in your stay with cosy rooms, lively communal spaces, convenient 24/7 services, and a bar you'll love for work and play at any hour. We're ready for you at The Hub!



Other local hotels include



Unity place

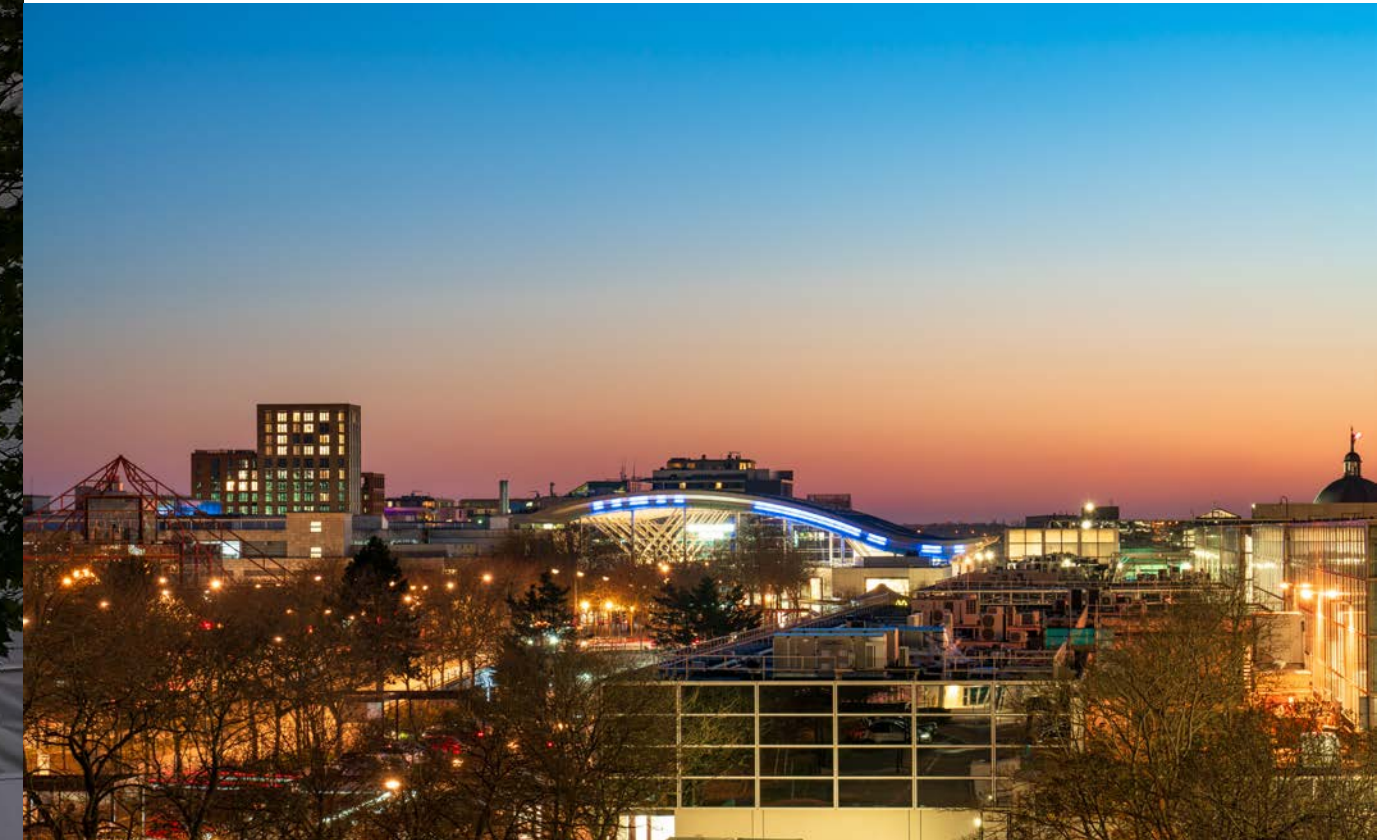

unity place

For more information email unityplaceevents@restaurantassociates.co.uk
or visit unityplace.co.uk/conference-events or call 01908 018595

